

SCALE: 1/2

1-1/2" SCHEDULE 40 POST (1.9" O.D.)

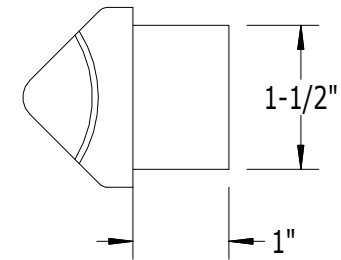
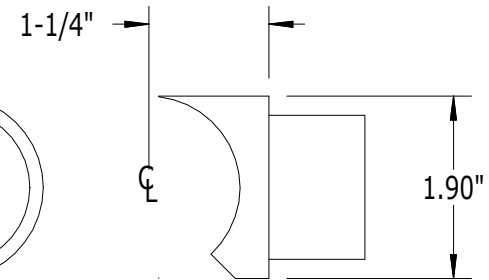
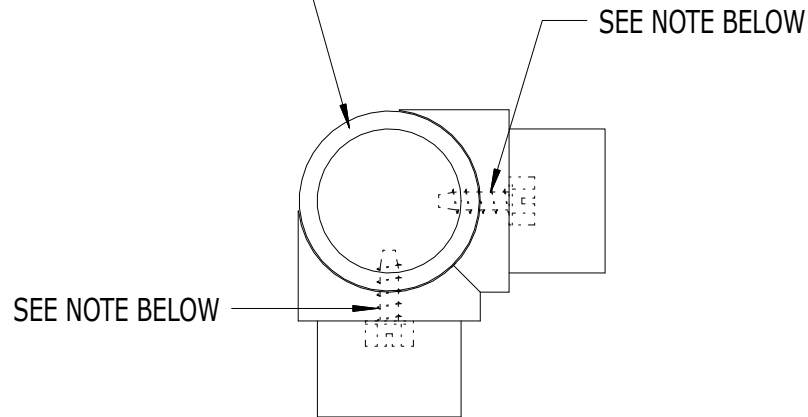

****A STAINLESS STEEL RIVET NUT (#529) AND A 1/4" x 1-1/4" S.S. SCREW (#526) ARE USED ON ALL TEE OR ANGLE TEE LOCATIONS THAT ATTACH TO JUST THE PIPE, AT ANY DEGREE.
NOTE: A STAINLESS STEEL RIVET NUT CAN NOT BE USED AT ANY LOCATION THAT WILL BE MOUNTING INTO A PORTION OF THE PIPE THAT IS FITTED WITH A REINFORCEMENT ROD.
A 1/4" x 1" S.S. SCREW (#527) IS USED ON ALL TEE LOCATIONS MOUNTING TO A PORTION OF THE PIPE THAT IS FITTED WITH A REINFORCEMENT ROD.**

| PART NO. | DESCRIPTION |
|----------|---------------------------------------|
| 503 | SERIES 500 CORNER POST TEE FITTING |

SUPERIOR
ALUMINUM PRODUCTS